



Innovative designs and a comprehensive range of windows suitable for the architectural, commercial, public, new build and retail markets are hallmarks of Smart Systems.

Our window ranges include casements (top/side hung, fixed lights and any combination of these), tilt and turn, hopper, tilt and slide, projecting, fully reversible, pivot (horizontal or vertical), sliding and heavy duty. Windows are available externally or internally beaded, open-in/open-out, with polyamide thermal barrier or as an aluminium/PVC-U composite frame for high performance thermal efficiency. High security glazing, shoot-bolt locking, dual colour options, excellent weather performance (BS6375 Pts 1 & 2), compliance with BS7950 and a choice of ovolo, chamfered or square main profiles are just some of the many special features of our window systems.



WINDOWS

Visoline

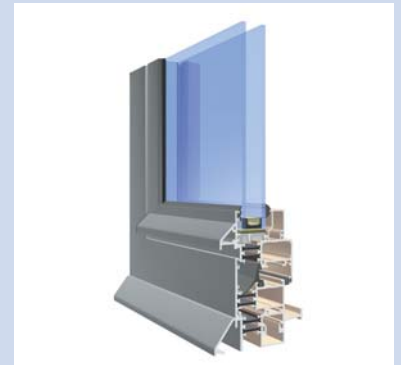

Horizontal Section

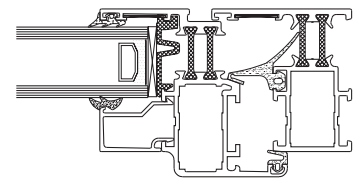

Vertical Section

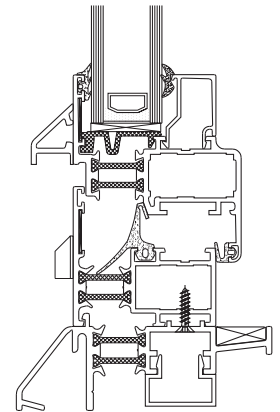

Trade Name

Visoline

Building applications

Designed for use as fixed lights, tilt and turn, single or double sash, side hung (open in/out), tilt in, side or top hung (open out), horizontal or vertical pivot and tilt and slide windows. All options are internally beaded for use on domestic and all commercial applications

Special features

All applications are internally glazed with square or round edge beads
Polyamide thermal break allowing dual colour option
Profiles span full height i.e. floor to ceiling

Materials

Aluminium alloy 6060/6063 T5/T6 in condition F22 to NBN P21-001 and DIN 1725

Thermal break: polyamide strips PA 6.6. 25% reinforced with glass fibre

Seals: EPDM to DIN 7863, TV 110
NFP 85301, ISO 3994

Finish

Polyester powder coat to BS 6496/APA-Qualicoat Guidelines. Anodised satin or bronze colours with EWAA/EURAS-Qualinod quality label
Dual colour available

Profile width

Various options depending on design considerations

Depth of frame

51mm

Glass

Glazing options from 4mm to 38mm

Sash inserts

See "Building Applications" above

Performance

Weather tested in accordance with BS6375 Pts 1
Security tested to BS7950
Tested to NEN-norm 5096. Security tested by SKG
Complies with Doc. L for thermal transmittance
Test Reports are available on request

